

GSA Approved | 71-204

Tip: mattress sizes (Not Included)- Twin 36" x 80", Full 54" x 80", Queen 60" x 80"

**Standard includes:**

- Solid hardwood posts and rails
- Species: **K** Oak or **M** Maple
- Deck: 3-piece wood
- Standard Finishes
- Shipped ready to assemble

**Options available:**

- Premium Finishes

Part Number	Description	D" x W" x H"
60BE3W4084-K	SHAKER (RH60), Bed, 3-Piece Deck, Twin, Uses Mattress Sized 36" x 80" - Not Included	40 x 84 x 37
60BE3W4084-M	SHAKER (RH60), Bed, 3-Piece Deck, Twin, Uses Mattress Sized 36" x 80" - Not Included	40 x 84 x 37
60BE3W5884-K	SHAKER (RH60), Bed, 3-Piece Deck, Full, Uses Mattress Sized 54" x 80" - Not Included	58 x 84 x 37
60BE3W5884-M	SHAKER (RH60), Bed, 3-Piece Deck, Full, Uses Mattress Sized 54" x 80" - Not Included	58 x 84 x 37
60BE3W6484-K	SHAKER (RH60), Bed, 3-Piece Deck, Queen, Uses Mattress Sized 60" x 80" - Not Included	64 x 84 x 37
60BE3W6484-M	SHAKER (RH60), Bed, 3-Piece Deck, Queen, Uses Mattress Sized 60" x 80" - Not Included	64 x 84 x 37

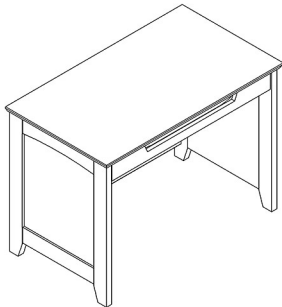

GSA Approved | 71-204

**Standard includes:**

- Desk case: solid hardwood with veneer plywood panels
- Worksurface: laminate with solid wood edges
- Drawer front: solid wood
- Standard Finishes
- Combination computer/ pencil drawer with 3/4 extension epoxy coated drawer slides, if selected
- 3/4 height modesty panel
- Dry-fit construction
- Shipped assembled

**Options available:**

- Premium Finishes

Part Number	Description	D" x W" x H"
60DEAZ42-Y	SHAKER (RH60), Desk, Slab Leg	24 x 42 x 30
60DEAZ48-Y	SHAKER (RH60), Desk, Slab Leg	24 x 48 x 30
60DEBD42-Y	SHAKER (RH60), Desk, Slab Leg, Full Width Combination Drawer	24 x 42 x 30
60DEBD48-Y	SHAKER (RH60), Desk, Slab Leg, Full Width Combination Drawer	24 x 48 x 30

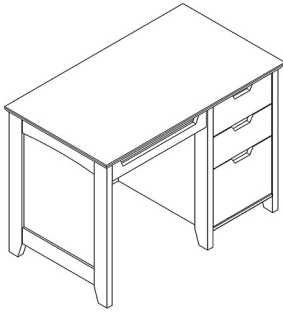

GSA Approved | 71-204

**Standard includes:**

- Desk case: solid hardwood with veneer plywood panels
- Worksurface: laminate with solid wood edges
- Drawer fronts: solid wood
- Standard Finishes
- Box/ Box/ File
- 3/4 extension epoxy coated drawer slides
- Integral pulls
- Dry-fit construction
- Shipped assembled

**Options available:**

- Premium Finishes

Part Number	Description	D" x W" x H"
60DEBG42-Y	SHAKER (RH60), Desk, Slab Leg, BBF	24 x 42 x 30
60DEBG48-Y	SHAKER (RH60), Desk, Slab Leg, BBF	24 x 48 x 30
60DEBK42-Y	SHAKER (RH60), Desk, Slab Leg, BBF, Computer Drawer	24 x 42 x 30
60DEBK48-Y	SHAKER (RH60), Desk, Slab Leg, BBF, Computer Drawer	24 x 48 x 30

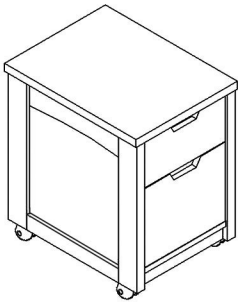

GSA Approved | 71-204

**Standard includes:**

- Case: solid hardwood with veneer plywood panels
- Top: laminate with solid wood edges
- Drawer fronts: solid wood
- Standard Finishes
- Box/ File
- 3/4 extension epoxy coated drawer slides
- Integral pulls
- Casters, non-locking: black plastic
- Dry-fit construction
- Shipped assembled

**Options available:**

- Premium Finishes

Part Number	Description	D" x W" x H"
60PE1X22-Y	SHAKER (RH60), Mobile Pedestal, BF, Casters	22 x 16 x 25



GSA Approved | 71-204

**Standard includes:**

- Case: solid hardwood with veneer plywood panels
- Top: laminate with solid wood edges
- Drawer fronts: solid wood
- Standard Finishes
- Box/ File or Box/ Box/ File configuration
- 3/4 extension nylon drawer slides
- Integral pulls
- Dry-fit construction
- Shipped assembled

**Options available:**

- Premium Finishes

Part Number	Description	D" x W" x H"
60PEM122-Y	SHAKER (RH60), Movable Pedestal, BF	22 x 16 x 25
60PEM322-Y	SHAKER (RH60), Movable Pedestal, BBF	22 x 17 x 28



GSA Approved | 71-204

**Standard includes:**

- Case: solid hardwood with veneer plywood panels
- Top: laminate with solid wood edges
- Drawer fronts: solid wood
- Standard Finishes
- 3/4 extension epoxy coated drawer slides
- Integral pulls
- Dry-fit construction
- Shipped assembled

**Options available:**

- Premium Finishes

Part Number	Description	D" x W" x H"
60DR3X30-Y	SHAKER (RH60), Chest, 3-Drawer	24 x 30 x 30
60DR4X30-Y	SHAKER (RH60), Chest, 4-Drawer	24 x 30 x 39
60DR6X30-Y	SHAKER (RH60), Chest, 6-Drawer	24 x 30 x 46

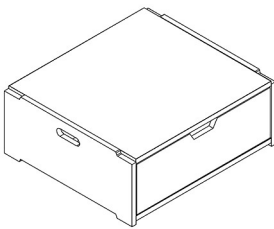

GSA Approved | 71-204

**Standard includes:**

- Case: solid veneer plywood
- Top: laminate with matching PVC edge band
- Standard Finishes
- Nest or stack 5-high
- Integrated safety connector clip at rear
- 3/4 extension epoxy coated drawer slides
- Integral pull
- Dry-fit construction
- Shipped assembled

**Options available:**

- Premium Finishes

Part Number	Description	D" x W" x H"
60DR1A26-Y	SHAKER (RH60), Single Drawer Stacker	24 x 26 x 10

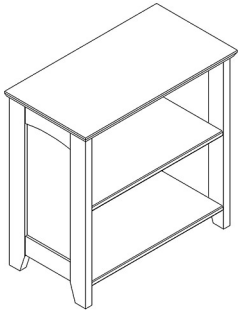

GSA Approved | 71-204

**Standard includes:**

- Case: solid hardwood with veneer plywood panels
- Top: laminate with solid wood edges
- Standard Finishes
- Adjustable shelf
- Dry-fit construction
- Shipped assembled

**Options available:**

- Premium Finishes

Part Number	Description	D" x W" x H"
60BK1S1230-Y	SHAKER (RH60), Bookcase, 1-Shelf	12 x 30 x 30
60BK1S1236-Y	SHAKER (RH60), Bookcase, 1-Shelf	12 x 36 x 30
60BK1S1630-Y	SHAKER (RH60), Bookcase, 1-Shelf	16 x 30 x 30
60BK1S1636-Y	SHAKER (RH60), Bookcase, 1-Shelf	16 x 36 x 30

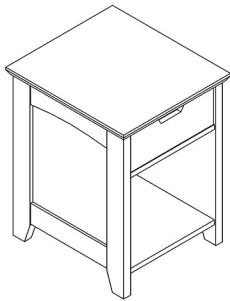

GSA Approved | 71-204

**Standard includes:**

- Case: solid hardwood with veneer plywood panels
- Top: laminate with solid wood edges
- Drawer front: solid wood
- Standard Finishes
- 3/4 extension epoxy coated drawer slides
- Integral pull
- Dry-fit construction
- Shipped assembled

**Options available:**

- Premium Finishes

Part Number	Description	D" x W" x H"
60NS1D19-Y	SHAKER (RH60), Night Stand, 1-Drawer	21 x 19 x 26

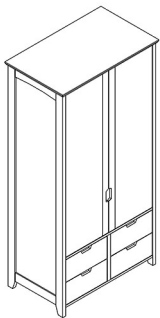

GSA Approved | 71-204

**Standard includes:**

- Case: solid hardwood with veneer plywood panels
- Top: plywood with solid wood edges
- Drawer fronts: solid wood
- Standard Finishes
- Drawers have 3/4 extension epoxy coated slides, if specified
- Closet rod
- Hook on inside of door
- Integral pulls
- Dry-fit construction
- Shipped assembled

**Options available:**

- Mirror
- Tower bar
- Premium Finishes

Part Number	Description	D" x W" x H"
60WAAI42-Y	SHAKER (RH60), Wardrobe, Closet Rod, Hook, 4-Drawer Split	24 x 42 x 74
60WABP36-Y	SHAKER (RH60), Wardrobe, Closet Rod, Hook, 2 Door	24 x 36 x 74

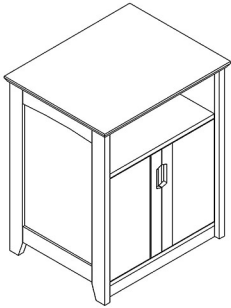

GSA Approved | 71-204

**Standard includes:**

- Case: solid hardwood with veneer plywood panels
- Top: laminate with solid wood edges
- Door fronts: solid wood
- Standard Finishes
- Open shelf with cable management grommet in back panel
- Adjustable shelf behind doors
- Integral pulls
- Dry-fit construction
- Shipped assembled

**Options available:**

- Premium Finishes

Part Number	Description	D" x W" x H"
60TVT136-Y	SHAKER (RH60), TV Stand, 2 Door, DVD Shelf	25 x 36 x 30

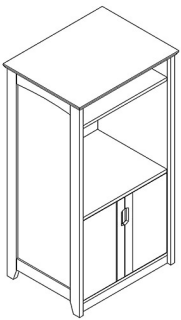

GSA Approved | 71-204

**Standard includes:**

- Case: solid hardwood with veneer plywood panels
- Top: plywood with solid wood edges
- Door fronts: solid wood
- Standard Finishes
- Slim shelf at top with cable management grommet in back
- Fixed height TV shelf with cable management grommet in back
- Adjustable shelf behind doors
- Integral pulls
- Dry-fit construction
- Shipped assembled

**Options available:**

- Premium Finishes

Part Number	Description	D" x W" x H"
60TVE136-Y	SHAKER (RH60), Entertainment Center, Fixed Shelf, 2 Doors	24 x 36 x 60